

1000-E06



370158

Bartscher GmbH
Franz-Kleine-Str. 28
D-33154 Salzkotten
Germany

Phone: +49 5258 971-0

Fax: +49 5258 971-120

Technical Support Hotline: +49 5258 971-197

www.bartscher.com



Version: 1.0

Date of preparation: 2020-04-08

Original instruction manual

1	Safety	2
1.1	Explanation of signal words	2
1.2	Safety instructions.....	3
1.3	Intended use	5
1.4	Unintended use.....	5
2	General information	6
2.1	Liability and warranty	6
2.2	Copyright protection.....	6
2.3	Declaration of conformity	6
3	Transport, packaging and storage	7
3.1	Delivery check	7
3.2	Packaging	7
3.3	Storage	7
4	Technical data	8
4.1	Technical specifications	8
4.2	List of components of the appliance.....	9
4.3	Functions of the appliance	9
5	Installation and operation	10
5.1	Installation.....	10
5.2	Operation	11
6	Cleaning and Maintenance	14
6.1	Safety Instructions for cleaning	14
6.2	Cleaning.....	14
6.3	Maintenance	16
7	Disposal.....	18



Read this instruction manual before using and keep it available at all times!

This instruction manual contains information about installation, operation and maintenance of the appliance and constitutes an important source of information and reference guide. The knowledge of all operational and safety instructions included in this manual is a prerequisite for safe and proper handling of the appliance. Additionally, accident prevention, occupational health and safety, and legal regulations in force in the area the appliance is used apply.

Before you start using the appliance, especially before turning it on, read this instruction manual in order to avoid personal injuries and property damages. Improper use may cause damage.

This instruction manual forms an integral part of the product and must be stored in an immediate vicinity of the appliance and be available at all times. The instruction manual should be transferred together with the appliance.

1 Safety

EN

This appliance has been manufactured in accordance with technical standards currently in force. However, the appliance may be a source of hazards if used improperly or contrary to its intended purpose. All persons using the appliance must consider information included in this instruction manual and observe safety instructions.

1.1 Explanation of signal words

Important safety instructions and warning information are indicated in this instruction manual with appropriate signal words. You must strictly follow the instructions, to prevent accidents, personal injuries and property damages.



DANGER!

The signal word **DANGER** warns against hazards that lead to severe injuries or death if the hazards are not avoided.



WARNING!

The signal word **WARNING** warns against hazards that may lead to moderate or severe injuries or death if the hazards are not avoided.



CAUTION!

The signal word **CAUTION** warns against hazards that may lead to light or moderate injuries if the hazards are not avoided.

IMPORTANT!

The signal word **IMPORTANT** indicates possible property damages, which may occur if safety instructions are not observed.

NOTE!

The symbol **NOTE** indicates subsequent information and guidelines for the user on usage of the appliance.

1.2 Safety instructions

Electrical current

- Too high a mains voltage or incorrect installation may cause electric shock.
- The appliance may be connected only if data on the rating plate correspond with the mains voltage.
- To avoid short-circuit, the appliance should be kept dry.
- If there are malfunctions during operation, disconnect the appliance from the power supply.
- Do not touch the appliance's plug with wet hands.
- Never take hold of the appliance if it has fallen into water. Immediately disconnect the appliance from the power supply.
- Any repairs or housing opening may be carried out by professionals and relevant workshops only.
- Do not transport the appliance, holding it by the power cord.
- Do not allow the power cord to come into contact with heat sources or sharp edges.
- Do not bend, pinch nor knot the power cord.
- Always completely unwind the power cord.
- Never place the appliance or other objects on the power cord.
- Always take hold of the plug to disconnect the appliance from the power supply.

Operating personnel

- The appliance may only be operated by qualified personnel and trained specialist personnel.
- This appliance may not be operated by persons (including children) with limited physical, sensory or mental capabilities, nor by persons with limited experience and/or limited knowledge.
- Children should be supervised to ensure that they are not playing with or switching on the appliance.

Improper use

- Unintended or prohibited use may cause damage to the appliance.
- The appliance may only be used when its technical condition is flawless and allows for safe operation.
- The appliance may only be used when all connections are executed according to rules of law in force.
- The appliance may only be used when it is clean.
- Use only original spare parts. Never attempt to repair the appliance on your own.
- Do not introduce any changes in the appliance nor modify it.

EN

Safety of Doner Kebab Knife Operation

- Exercise extreme caution when operating the appliance; the blade is very sharp and it poses the danger of cutting!
- Switch the appliance on only after its complete and correct assembly. To this end, read indications in section 'Operation'.
- Do not use the appliance with damaged blade protection or with damaged blade protective ring.
- Control movable elements of the appliance regularly. Make sure there are no doubts as to their operational condition, that they do not seize, and thus do not negatively influence the appliance's operation. Before continuing to operate, order the repair or replacement of damaged parts.
- Always switch the appliance off (set the ON/OFF switch to 'O' position) before placing it down.
- Before disassembling/assembling elements of the appliance or before cleaning it, disconnect the appliance from the mains (pull the plug out).

Health Hazard Posed by Germs Due to Insufficient Hygiene

- At the end of a working day, thoroughly clean and disinfect the appliance, according to indication provided in the instruction manual. Insufficient hygiene poses an infection risk for a consumer.

Safety

- Pay attention to cleanness at a work stations; regularly clean and disinfect working surfaces.
- Control the used auxiliaries (e.g., scraper, divider) daily for cleanness and proper operation. Immediately replace damaged elements.
- If you do not wash hands, germs may deposit on them and be transferred to food products. Wash hands before and after contact with food products.

1.3 Intended use

As described below, every use of the appliance for a purpose differing and/or diverging from its intended standard use, is prohibited and considered to be an unintended use.

The following is an intended use:

- Cutting of correctly layered grilled meat.

1.4 Unintended use

An unintended use may lead to personal injuries or property damages caused by hazardous voltage, fire or high temperature. The appliance may only be used to perform tasks described in this instruction manual.

2 General information

2.1 Liability and warranty

All information and instructions in this instruction manual account for legal regulations in force, current level of technical engineering knowledge as well as our expertise and experience, developed over the years. If special models or additional options are ordered, or state-of-the-art technical solutions were implemented, the actual scope of delivery of the appliance may, in some circumstances, differ from descriptions and numerous drawings in this instruction manual.

The manufacturer is not liable for any damages nor faults stemming from:

- failure to observe instructions,
- unintended use,
- technical alterations introduced by the user,
- usage of unapproved spare parts.

We reserve the right to introduce technical modifications to the product, intended for improvement of the appliance and its performance.

EN

2.2 Copyright protection

This instruction manual, and texts, drawings and images included in it, as well as its other components are copyright protected. It is prohibited to reproduce this instruction manual (including its excerpts), in any form and by any means, and to use and/or transfer its content to third parties without manufacturer's written permission. Violation of the above results in obligation to pay compensation. We reserve the right to claim further damages.

2.3 Declaration of conformity

The appliance meets the currently applicable standards and guidelines of the European Union. We confirm the above in the EC Declaration of Conformity. We may provide relevant Declaration of Conformity upon request.

3 Transport, packaging and storage

3.1 Delivery check

Immediately upon reception, check the delivery for completeness and possible shipping damage. In the case of visible transport damage refuse to accept the appliance or accept it conditionally. Mark and note the scope of damage in shipping documents/consignment list of the shipping company and lodge a complaint. Concealed damage must be reported immediately upon its discovery, as compensation claims may only be filed within applicable time limits.

If you find that parts or accessories missing, please contact our Customer Service Department.

3.2 Packaging

Do not dispose of the appliance cardboard box. It may be used to store the appliance when relocating or when shipping the appliance to our service point in the case of any damages.

The packaging and its elements are made of recyclable materials. Particularly, these are: plastic films and bags, cardboard box.

When disposing of the packaging, observe applicable domestic regulations. Recyclable packaging materials should be recycled.

EN

3.3 Storage

Leave the packaging closed until installation of the appliance; observe external indications concerning method of placing and storage. Store the packaging in the following conditions only:

- in closed rooms;
- in dry and dust-free surrounding;
- away from aggressive agents;
- in a location protected against sunlight;
- in a location protected against mechanical shocks.

In the case of extended storage (over three months), make sure you check the condition of the packaging and the parts regularly. If needed, replace the packaging with a new one.

4 Technical data

4.1 Technical specifications

Name:	Doner kebab knife 1000-E06
Art. No.:	370158
Material:	Stainless steel, plastic
Blade design:	Stainless steel, smooth
Blade diameter, in mm:	100
Cutting thickness, in mm:	0 - 6
Rotational speed (RPMs):	2.560
Degree of protection:	2
Cord length, in m:	2,8
Power supply:	0.08 kW / 230 V / 50 Hz
Dimensions (W x D x H), in mm:	128 x 190 x 256
Weight in kg:	1,4

EN

We reserve the right to implement technical modifications!

Version / Characteristics

- Design: electronic
- Control: electronic
- Adjustable cutting thickness
- Blade protective cover
- Overload protection
- ON/OFF switch
- The set includes:
 - 1 spare blade
 - 1 sharpening stone

4.2 List of components of the appliance



- | | |
|--------------------------------------|-------------------------------------|
| 1. Cutting thickness adjustment bolt | 2. Blade protective ring |
| 3. Grip | 4. Power cord with protective cover |
| 5. Plug | 6. RESET button |
| 7. ON/OFF switch | 8. Knurled screw (2 pcs) |
| 9. Blade | 10. Blade protective cover |
| 11. Blade retaining screw | |

4.3 Functions of the appliance

The Doner kebab knife has been designed solely for cutting of correctly layered grilled meat; cutting movements are effected in vertical direction only, from top to bottom. Owing to smooth stainless steel blade of the Doner kebab knife, meat may be flexibly and precisely cut into fine pieces.

5 Installation and operation

5.1 Installation

Unpacking

- Unpack the appliance and remove all external and internal packaging elements.



CAUTION!

Choking hazard!

Prevent children from accessing packaging materials, for instance: plastic bags and EPS.

- Be careful not to damage the rating plate and warning labels affixed to the appliance.

Operation Location

- Makes sure that power connection is easily accessible for the purpose of rapid disconnection of the appliance from mains socket, should this be necessary.
- Always place the appliance on dry, clean surface.
- Keep the appliance and the power cord away from hot surfaces. They may melt under the influence of heat.
- Pay attention to how the power cord is trailing, so that it is not damaged on sharp edges nor cut by movable elements of the appliance.

Power supply connection

- Verify if technical data of the appliance (see rating plate) correspond with the local electric power grid specification.
- Connect the appliance to a single, properly grounded mains socket with protective contact. Do not connect the appliance to a multi-socket.
- The power cord should be laid in a way preventing anyone from threading on it or tripping against it.

5.2 Operation



WARNING!

Danger of cut wounds inflicted by sharp blade!

Always be careful when removing and assembling the blade.

Use proper safety gloves.

Danger of injuries!

Operate the appliance with one hand only.

When operating the appliance, do not touch it nor the cut products with your other hand.

Preparation of the Appliance

1. Before the first use, thoroughly clean the appliance according to the instructions in section 'Cleaning'.
2. Thoroughly dry the washed elements.
3. Make sure that all removed elements are reassembled correctly on the appliance.



4. Use the adjustment bolt in top section of the appliance to set the required cutting thickness.

The cutting thickness may be set in the range of 0.5–8 mm.

5. Rotate the adjustment bolt counter-clockwise, to increase the cutting thickness, and clockwise — to decrease it.

EN

Indications for Handling Food Products

- Heat meat to at least 70°C.
- Store meat in temperature of below 5°C or freeze it in temperature of below -18°C.
- Avoid direct contact between raw and prepared food products.

Cutting Meat

1. Prepare meat for selected courses.

The layered kebab meat is grilled from outside to the inside, with meat at the inside remaining raw at the beginning. When the external layer is grilled, it may be cut with kebab knife.

2. Plug the appliance into a suitable single socket.
3. When cutting, always apply the kebab knife at the top portion of meat.
4. When the appliance is applied at the top, switch the ON/OFF switch to 'I' position.

The blade is starting to run.

5. Cut meat with the kebab knife drawn with one hand from top to bottom.
6. When the external layer is cut off, switch the appliance off immediately (set the ON/OFF switch to 'O' position).
7. Continue grilling meat and repeat the steps described above.

Switching the Appliance Off

EN

1. After use, switch the appliance off and disconnect it from power supply (pull the plug out).

Overload Protection

The appliance is equipped with the overload protection. In the event of overheating due to too long an operation or overload, this feature switches the appliance off automatically.

Leave the appliance to cool down for some time, and then press the RESET button at the bottom of the housing, to reset the appliance back to operational condition.

Blade Disassembly / Assembly



WARNING!

Sharp blade may inflict deep cut wounds!

Exercise utmost caution when disassembling and assembling the blade!

Use gloves resistant to cutting.

ATTENTION!

Disconnect the appliance from power supply (pull the plug out) before disassembling the blade.

Perform the following steps:

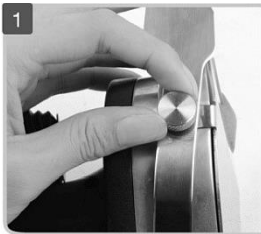

Undo both knurled screws on the blade protective ring.



Carefully remove from the appliance the blade protective ring with blade cover.



Undo the blade retaining screw and carefully remove the blade from the appliance.



CAUTION!

Incorrect installation of the blade influences negatively the correct operation of the appliance.

The blade or a new blade should be fitted on the retaining disk, always with the sharpened side towards the motor.

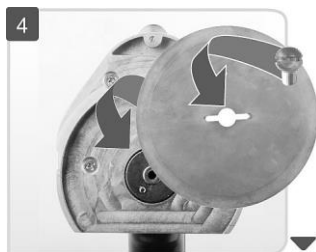

Assemble the blade and tighten it with the retaining screw.



Using both knurled screws, reassemble the blade cover, with blade protective ring onto the appliance.

EN

6 Cleaning and Maintenance

6.1 Safety Instructions for cleaning

- Before cleaning, disconnect the appliance from the power supply.
- Leave the appliance to cool down completely.
- Make sure water does not enter the appliance. Do not immerse the appliance in water or other liquids during cleaning. Do not clean the appliance with a pressurized water jet.
- Do not use any sharp or pointed, nor metal implements (knife, fork, etc.). Sharp or pointed implements may damage the appliance, and when in contact with live parts, they may cause electric shock.
- For cleaning, do not use any scouring agents that contain solvents nor corrosive cleaning agents. They may damage the surface.

6.2 Cleaning

1. Clean the appliance regularly at the end of a working day.

ATTENTION!

Do not clean the appliance or its detachable parts in a dishwasher.

2. Use only food-grade agents for cleaning:
 - mild cleaning agent
 - degreasing agent
 - disinfecting agent
 - hot water
3. Remove extensive soiling from the appliance with a suitable sponge or dish-washing cloth.
4. Spray external surfaces with degreasing agent.
5. Remove the blade from the appliance. Follow steps 1–3 described in section 'Blade Disassembly/Assembly'.
6. Spray the blade and blade protective cover with disinfecting agent. Leave for at least 5 minutes so that the agent starts acting.
7. Wash all the disassembled parts in warm running water with a mild cleaning agent.
8. Rinse all parts with fresh water.
9. Dry all surfaces with a linen-free cloth.
10. Refit the blade and blade protective cover in the appliance. Follow steps 4–5 described in section 'Blade Disassembly/Assembly'.

11. Wipe the housing and power cord with a soft, damp cloth only.



6.3 Maintenance

Blade Sharpening



WARNING!

Hazard of concussion or cut wounds when sharpening the blade!

Incorrect use of the sharpening stone may cause it to hook between the blade and blade protective cover and thus to seize it.

Pay attention to proper operation of the sharpening stone.

Injury hazard to eyes from metal chips!

Wear safety glasses when performing sharpening.

The blade must be regularly sharpened, i.e. after cutting of approx. 50 kg of meat. If after repeated sharpening operations the blade diameter reduces by more than 2 cm, replace the blade with a new one.

EN

1. Clean the appliance and blade thoroughly, observing indications provided in section 'Cleaning'.
2. Use the adjustment bolt to set the largest possible cutting thickness (rotate counter-clockwise).
3. Plug the appliance into a suitable single socket.
4. Hold the appliance in a way making it possible to switch it on or off with one hand; hold the sharpening stone in your other hand.

Cleaning and Maintenance

5. To sharpen the blade, perform the following steps:



Place the sharpening tool under the blade at a very flat angle. Switch the appliance on with the ON/OFF switch for 1–2 seconds.



To remove burrs, place the sharpening stone at the top side of the blade.

Again start the appliance for a brief moment and remove burrs on top of the blade.



To end with, remove the blade for cleaning (section 'Blade Disassembly/Assembly', steps 1–3). Clean and disinfect according to indications in section 'Cleaning'.



Reassemble the blade on the retaining disk and tighten to the appliance with retaining screw.



Using both knurled screws, assemble the blade cover with blade protective ring.

7 Disposal

Electrical appliance



Electric appliances are marked with this symbol. Electrical appliances must be disposed of and recycled in a correct and environmentally friendly manner. You must not dispose of electric appliances with household waste. Disconnect the appliance from the power supply and remove power cord from the appliance.

Electrical appliances should be returned to designated collection points.